

|            |                     |                |                  |             |          |
|------------|---------------------|----------------|------------------|-------------|----------|
| TOLERANCE  | TAPE MEASURE ±1/16" | CALIPER ±.010" | DRAWING APPROVED | BOM ENTERED | ALLOY    |
| OVERRIDDEN |                     |                |                  |             | COMMENTS |

| REV | NOTES |
|-----|-------|
|     |       |

**Aluminum-Fence.com** **888-348-4695**  
 An Outdoor Solutions Company Online Since 1996

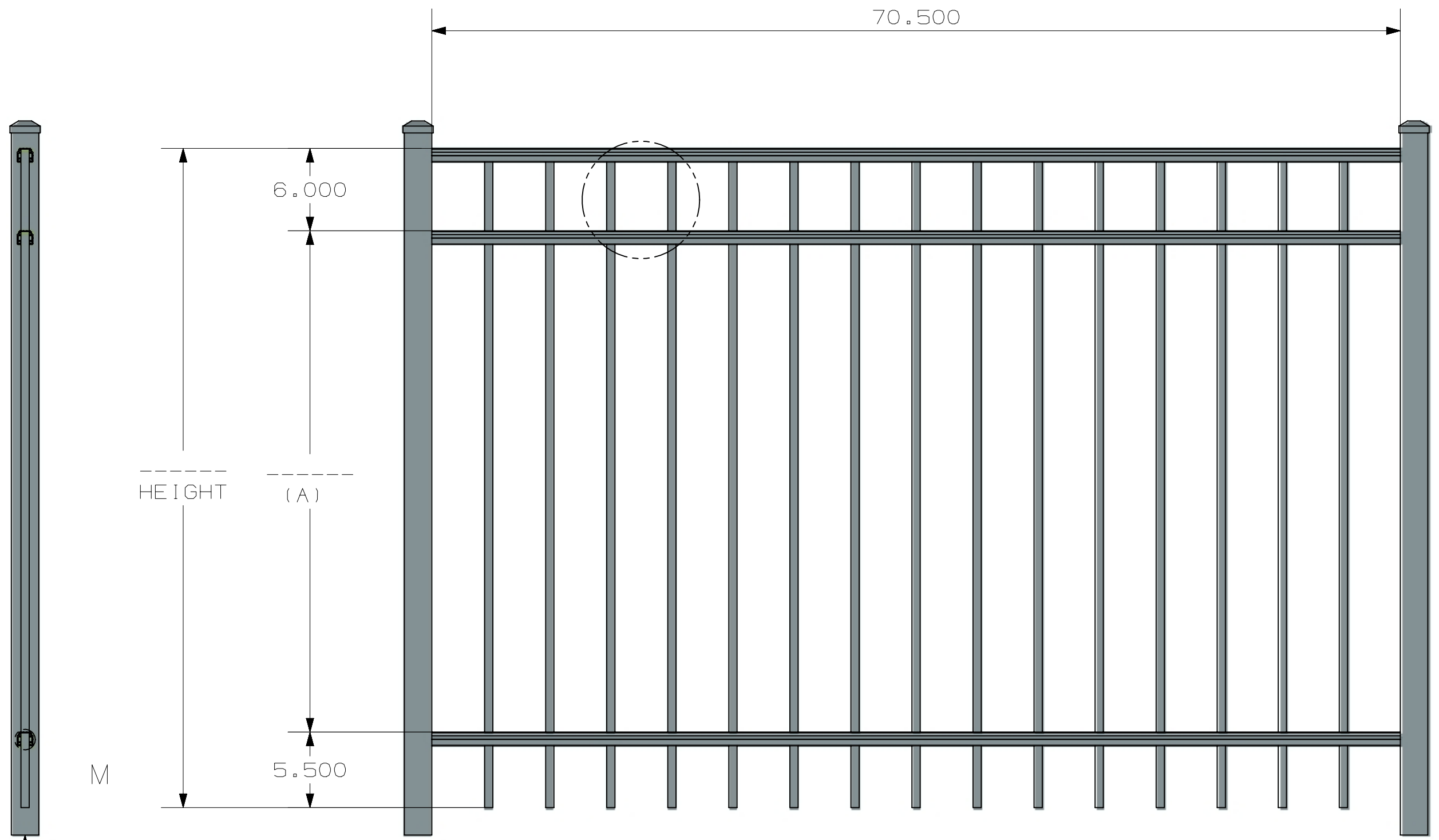
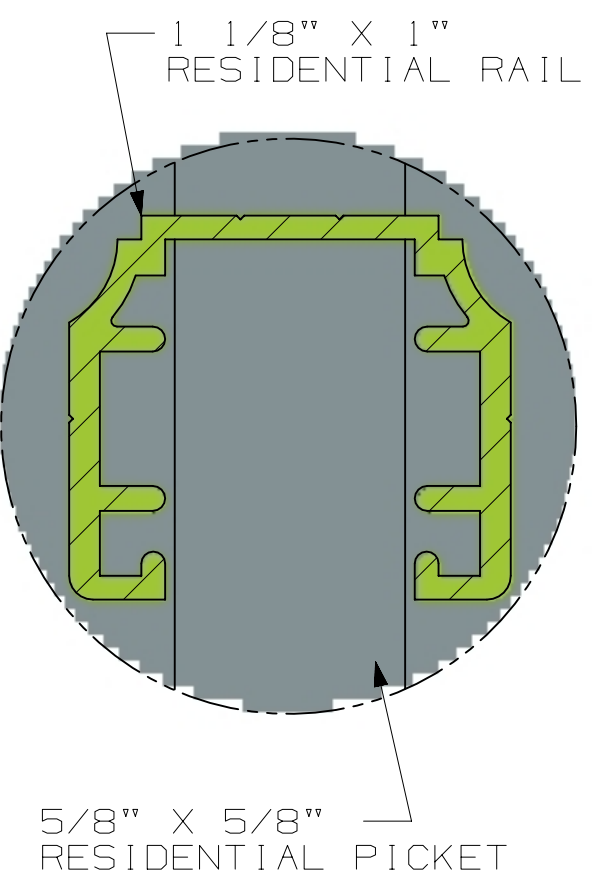
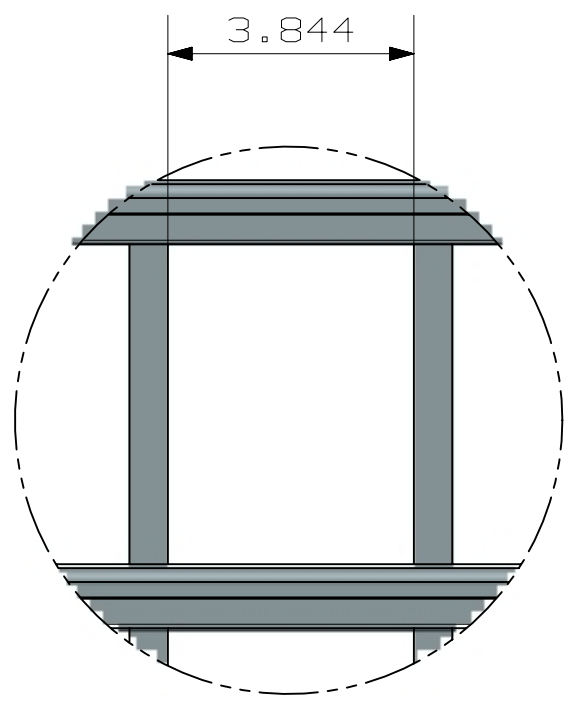

- POST OPTIONS  
 2" x 2" x .060" WALL  
 2" x 2" x .080" WALL  
 2" x 2" x .125" WALL  
 2 1/2" x 2 1/2" x .100" WALL

| HEIGHT | (A)     |
|--------|---------|
| 3'     | 24 1/2" |
| 3 1/2' | 30 1/2" |
| 4'     | 36 1/2" |
| 4 1/2' | 42 1/2" |
| 5'     | 48 1/2" |

| INSIDE OF POST WIDTH |          |
|----------------------|----------|
| NOMINAL              | ACTUAL   |
| 5'                   | 61.6875" |
| 6'                   | 70.5"    |
| 7'                   | 83.875"  |

ULTRA ALUMINUM MANUFACTURING, INC  
 2124 GRAND COMMERCE DR. HOWELL, MI 48855  
 PHONE (800) 656-4420 FAX (800) 643-7426

|  |       |            |
|--|-------|------------|
|  | DATE  | 12-12-2023 |
|  | REV   | 1          |
|  | SHEET | 1 OF 1     |

RESIDENTIAL  
 UAF - 200 FLAT TOP  
 STD BOTTOM  
 3 - RAIL

UAF-200 FLAT TOP STD BOTTOM RESIDENTIAL 6X4 3 RAIL