

# iDeal

aluminum

## Estate Gates

SINGLE SWING - DOUBLE SWING



## GATE DETAILS

### Bell Arch Shown as \*8330

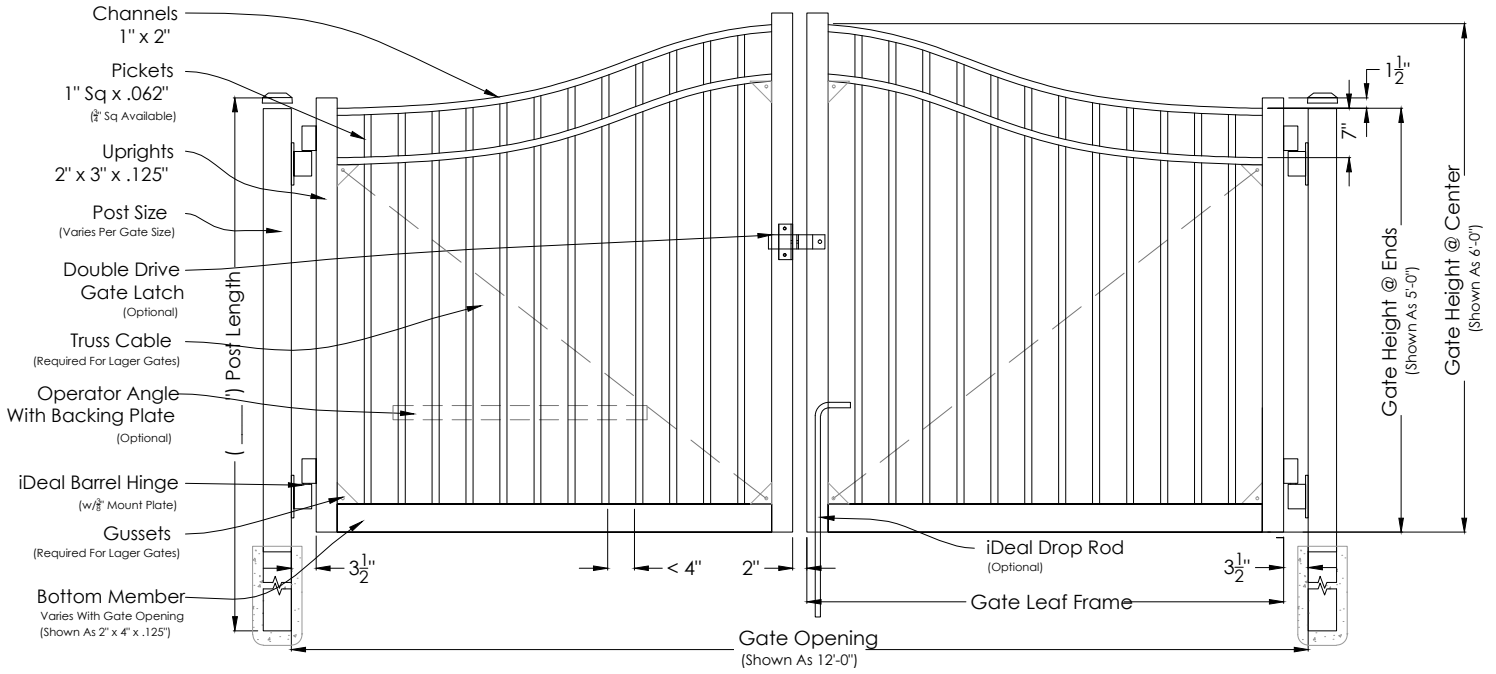

### Scalloped Shown as \*8320

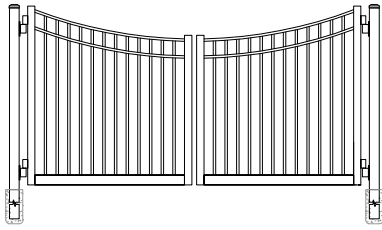

### Dome Arch Shown as \*8330

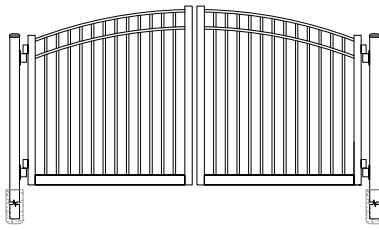

### Straight Shown as \*8300

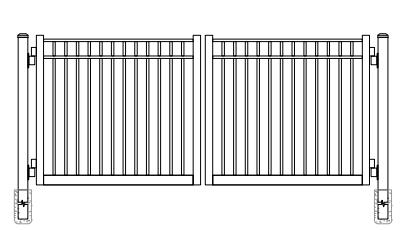

Ideal is the clearly recognized industry leader in both innovation and craftsmanship for all styles of gates. This matters because almost all interaction a customer has with barriers is at the gate. Aesthetics, workmanship, stability and durability are essential for the lifetime of any gate. Ideal provides estate gates in a variety of heights and widths. Customers may choose from single swing or double swing gates to match their fence style. Each estate gate is custom designed and engineered. Our Ideal gates are fully welded with heavy framework to prevent deflection and sagging.

## IDEAL BARREL HINGE OPTIONS

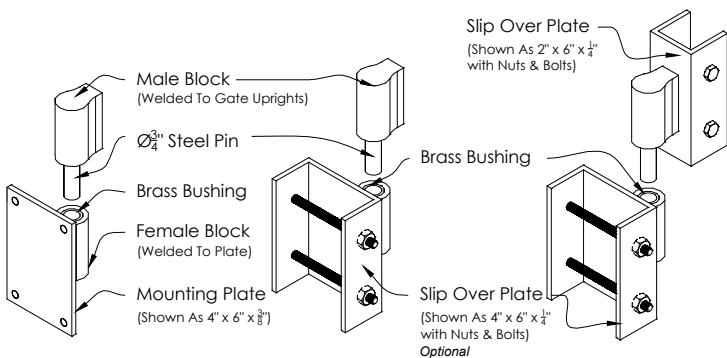

Option A  
Standard

Option B  
Slip Over

Option C  
Dual Slip Over

## IDEAL DOUBLE DRIVE LATCH

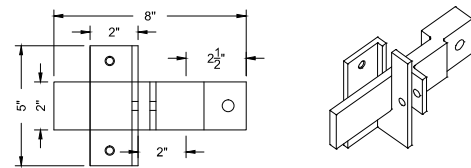

- Gates designed to match your Ideal fence
- All estate gates are available in single swing and double swing
- Double swing gates with up to 40' openings
- Hardware included with gates
- All estate gates are available with 3/4" or 1" Pickets
- Over 60 standard gate styles
- Custom estate gates available
- Idealcoat 2604 standard powder coating

## STANDARD COLORS



Black

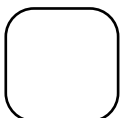

White



Bronze



\*actual colors may vary

**Aluminum-Fence.com**

An Outdoor Solutions Company

Online Since 1996

**888-348-4695**