

iDeal

aluminum

Fence Collection

RESIDENTIAL - PARKWAY - COMMERCIAL - INDUSTRIAL

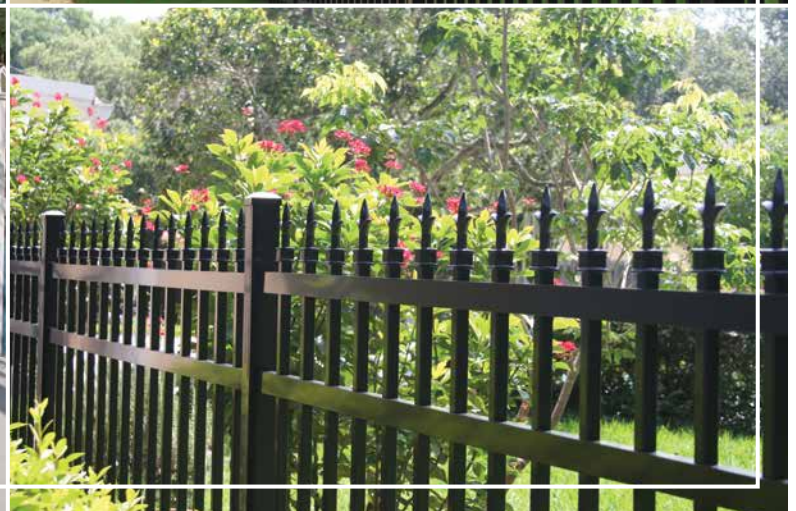

FENCE STYLES

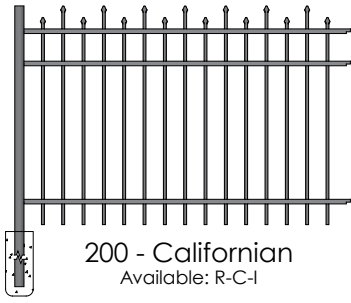

200 - Californian
Available: R-C-I

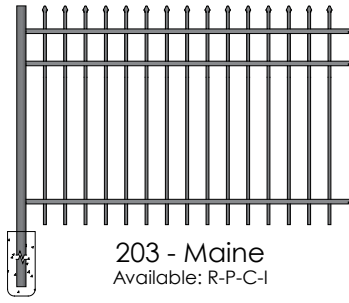

203 - Maine
Available: R-P-C-I



300 - Long Islander
Available: R-P-C-I

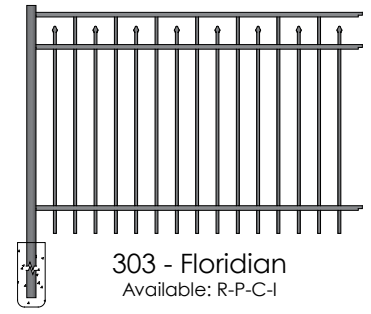

303 - Floridian
Available: R-P-C-I



400 - Alamo
Available: R-C-I



403 - Carolina
Available: R-C-I

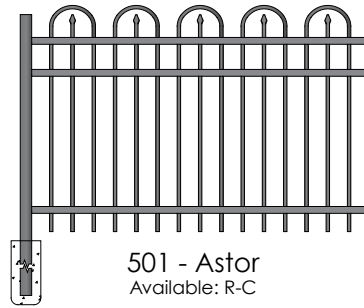

501 - Astor
Available: R-C



502 - Vanderbilt
Available: R-C

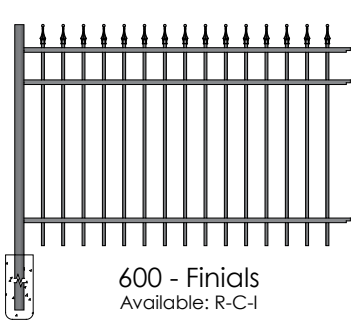

600 - Finials
Available: R-C-I

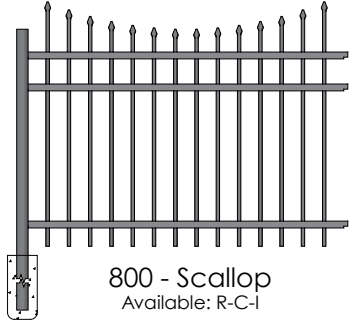

800 - Scallop
Available: R-C-I

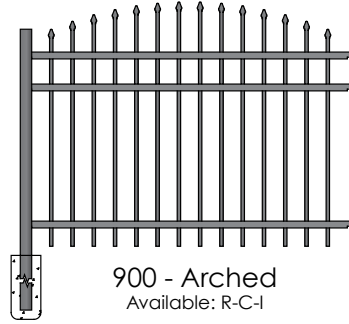

900 - Arched
Available: R-C-I

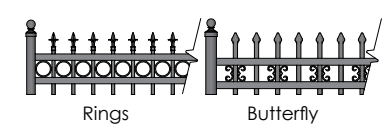

Ideal offers four series of aluminum fence to meet your needs. Additional picket spacing and rail height options are available. Ideal's elegant ornamental aluminum fencing, with Idealcoat powder coated finish, provides a maintenance-free fence that will last for years. All of our styles are sleekly designed, with clean lines, and add a unique finishing touch to any outdoor space.

PICKETS AND CHANNELS

Residential Parkway Commercial Industrial

Pickets



5/8" x 5/8"



1" x 5/8"



3/4" x 3/4"

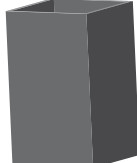

1" x 1"

Rails

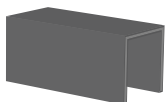

1" x 1-1/16"

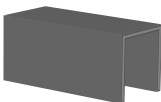

1" x 1-1/16"

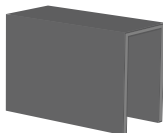

1-1/2" x 1-1/16"

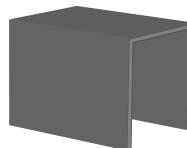

1-5/8" x 1-5/8"

STANDARD COLORS



Black

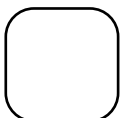

White



Bronze



*actual colors may vary

| COMPONENTS | RESIDENTIAL | PARKWAY | COMMERCIAL | INDUSTRIAL |
|------------------------------|---|--|--|--|
| PICKET: | 5/8"sq. x .050" | 1" x 5/8" x .045" | 3/4"sq. x .060" | 1"sq. x .062 |
| RAILS: TOP WALL SIDE WALL | 1-1/16" x .062" 1" x .072" | 1-1/16" x .062" 1" x .072" | 1-1/16" x .062" 1-1/2" x .072" | 1-5/8" x .075" 1-5/8" x .100" |
| PICKETS 6' SECTION: | 15 | 13 | 14 | 13 |
| PICKETS 8' SECTION: | NA | NA | 19 | 18 |
| STANDARD POST: | 2" x 2" x .062" 2" x 2" x .093" 2.5 x 2.5 x .075" | 2" x 2" x .062" 2" x 2" x .093" 2.5 x 2.5 x .075" | 2" x 2" x .062" 2" x 2" x .093" 2.5 x 2.5 x .075" 3" x 3" x .093" | 2.5 x 2.5 x .075" 3" x 3" x .093" |
| GATE POST: | 2" x 2" x .125" 2.5" x 2.5" x .125" 3" x 3" x .125" 4" x 4" x .125" | 2" x 2" x .125" 2.5" x 2.5" x .125" 3" x 3" x .125" 4" x 4" x .125" | 2" x 2" x .125" 2.5" x 2.5" x .125" 3" x 3" x .125" 4" x 4" x .125" | 2.5" x 2.5" x .125" 3" x 3" x .125" 4" x 4" x .125" 6" x 6" x .125" |
| PICKET SPACING: | < 4" TYP. | < 4" TYP. | < 4" TYP. | < 4" TYP. |
| INSTALLED CENTERS: | 72" o/c 2" post | 70-1/2" o/c 2" post | 71-1/8" o/c 2" post 94-3/4" o/c 2.5" post | 71" o/c 2.5" post 96" o/c 2.5" post |
| HEIGHTS: | 36", 42", 48" 54", 60", 72" | 36", 42", 48" 54", 60", 72" | 36", 42", 48" 54", 60", 72" | 36", 48", 60" 72", 84", 96" |
| ALLOY: | 6063 T5 alloy on pickets, posts, rails. 6005 T5 alloy available on posts and rails | 6063 T5 alloy on pickets, posts, rails. 6005 T5 alloy available on posts and rails | 6063 T5 alloy on pickets, posts, rails. 6005 T5 alloy available on posts and rails | 6063 T5 alloy on pickets, posts, rails. 6005 T5 alloy available on posts and rails |

Aluminum-Fence.com

An Outdoor Solutions Company

Online Since 1996

888-348-4695